

Appendix E
Rip-Rap Borrow Source Maps

Appendix E

Rip-Rap Borrow Source Maps

The following are a list of the rip-rap borrow source maps contained in this appendices:

- ICPP rip-rap source
- STF rip-rap source
- Dike Road rip-rap source
- Organic-Moderated Reactor Experiment/STF rip-rap source
- Antelope substation rip-rap source.

ICPP RIP RAP SOURCE

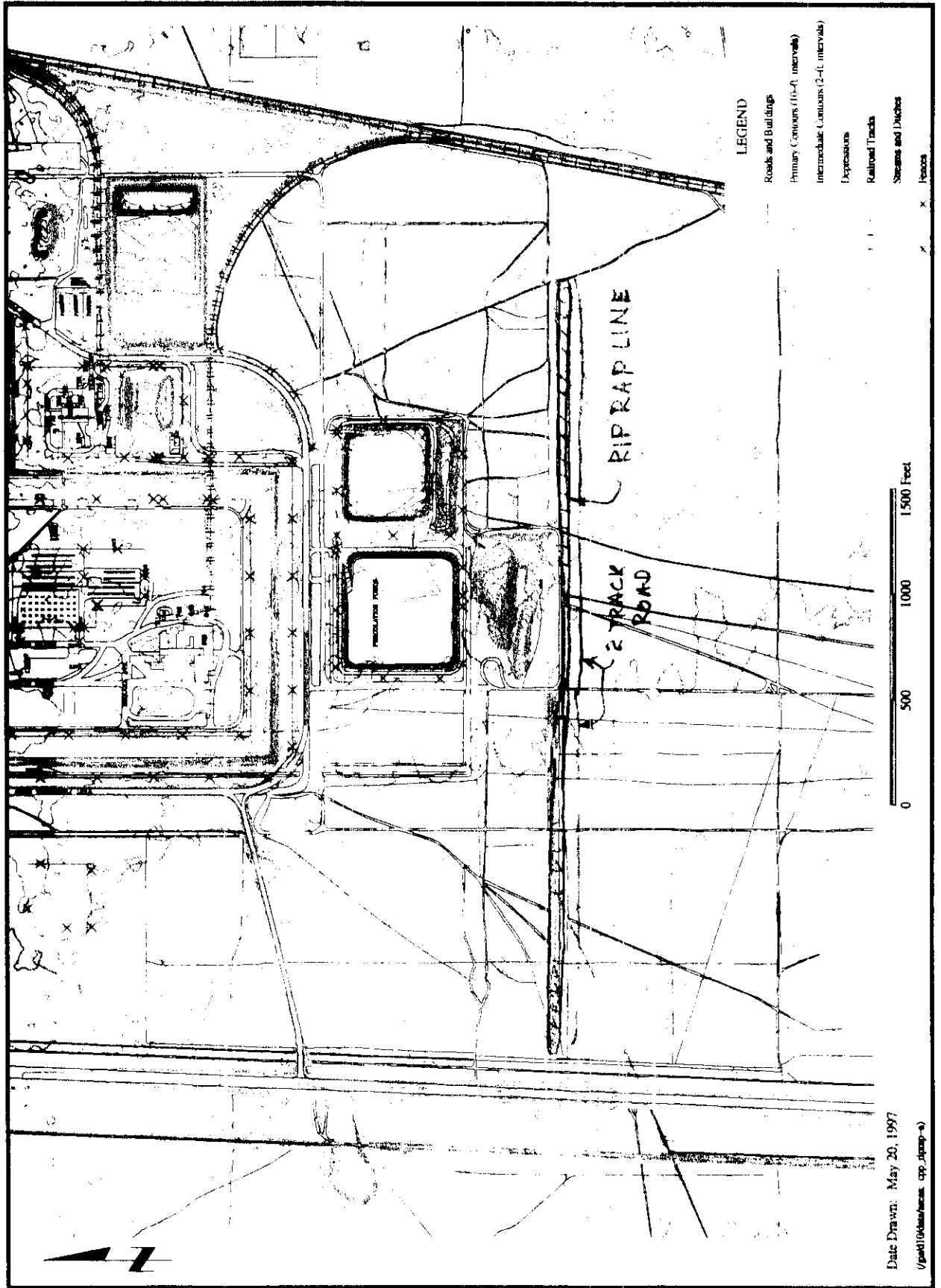

Date Drawn: May 20, 1997
 (\\p010\des\hans.cpp\jppp-4)



DR	SHEET	OF	JOB NO.	SKETCH NO.	REV
CK					

MAP OF PROPOSED RIP-RAP SOURCE FOR SL-1 ENGINEERED BARRIER;

- 1) DIRT ROADS SHOWN ON MAP TO BE GROOMED AND WATERED DURING RIP-RAP HAULING, AND ARE TO REMAIN SINGLE LANE.
- 2) ALL DISTURBANCES, NEW ROADS AND TRAILS TO BE RE-CONTOURED AND SEEDED W/CRESTED WHEATGRASS AFTER HAULING IS COMPLETED, PER IT CORP. CONTRACT.

PARSONS



STF SITE

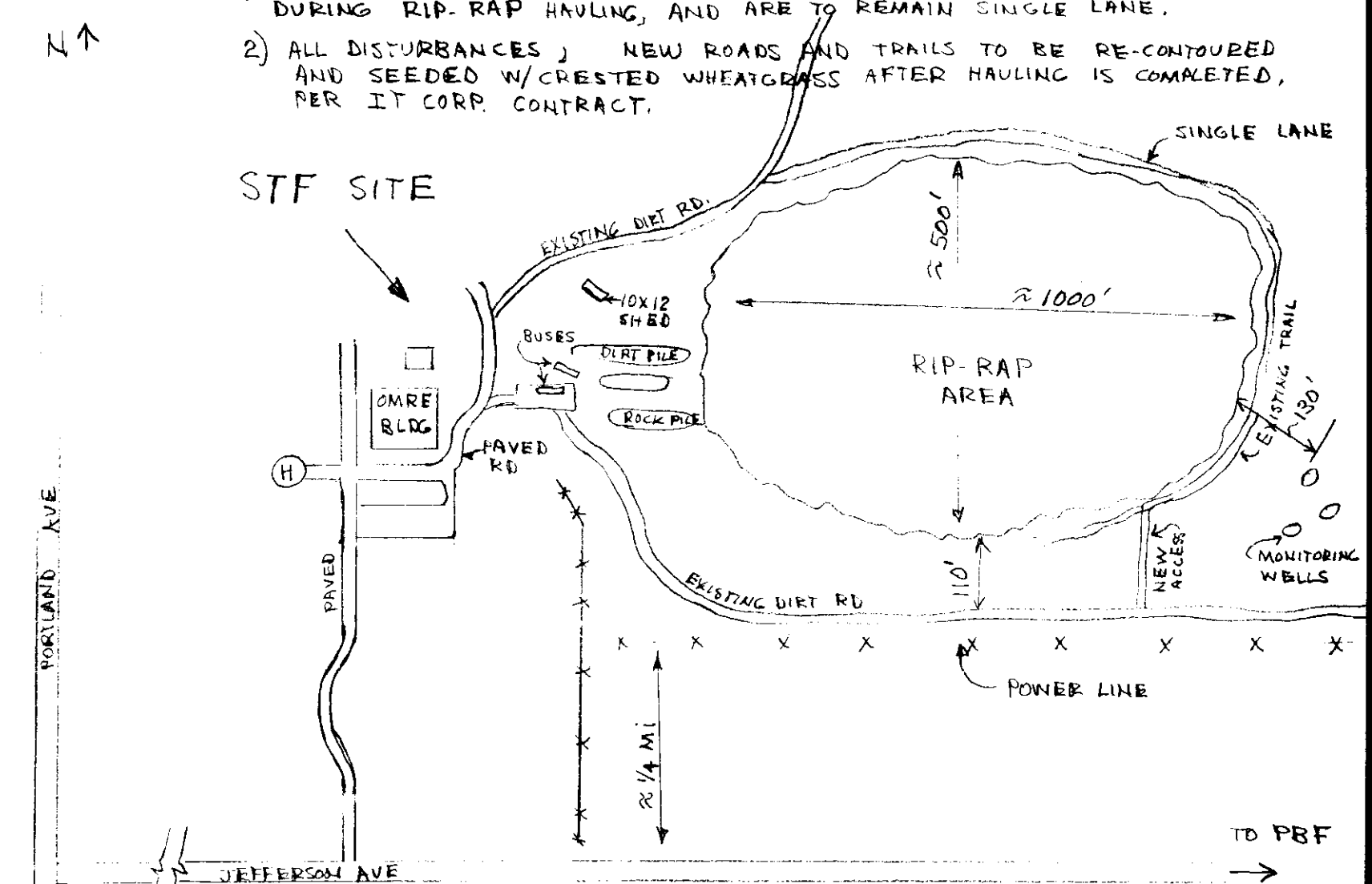

DR	CK
SHEET	OF
JOB NO.	
SKETCH NO.	
REV	

REV 1
SL-1 ENGINEERED BARRIER
SWPPP - CA

APPROVALS	
<i>[Signature]</i> (Parsons Project Mgr)	10-15-96
<i>[Signature]</i> (LMTG PM)	10/15/96
<i>[Signature]</i>	10-16-96

TO PBF
→



PARSONS

DR
OK

SHEET OF JOB NO.

SKETCH NO.

REV

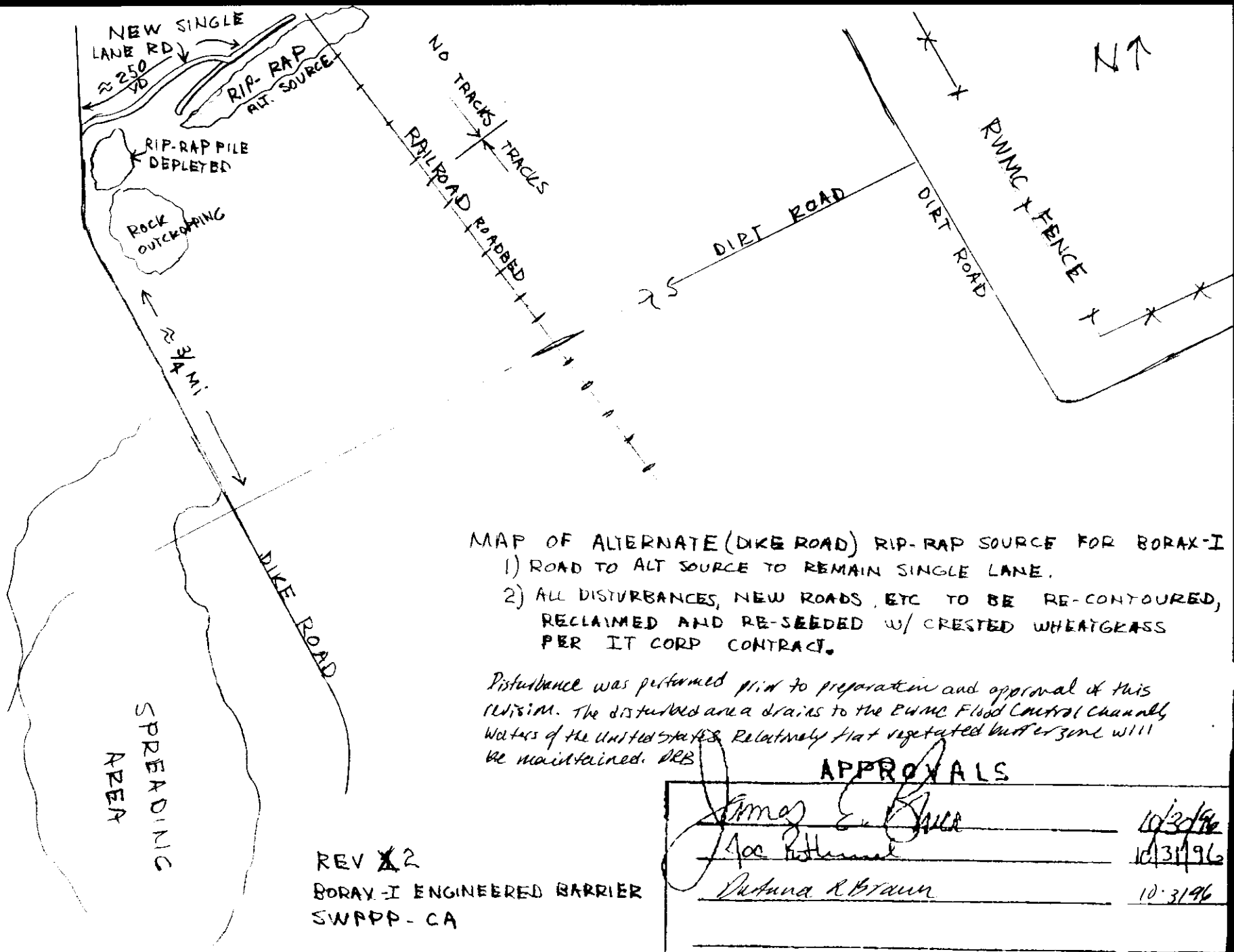

MAP OF ALTERNATE (DIKE ROAD) RIP-RAP SOURCE FOR BORAX-I

- 1) ROAD TO ALT SOURCE TO REMAIN SINGLE LANE.
- 2) ALL DISTURBANCES, NEW ROADS, ETC TO BE RE-CONTOURED, RECLAIMED AND RE-SEEDED W/ CRESTED WHEATGRASS PER IT CORP CONTRACT.

Disturbance was performed prior to preparation and approval of this revision. The disturbed area drains to the RWMC Flood Control Channel, Waters of the United States. Relatively flat vegetated buffer zone will be maintained. JEB

APPROVALS

<i>James E. Bruce</i>	10/30/96
<i>Joe K... ..</i>	10/31/96
<i>Diana R. Brown</i>	10/31/96

REV X2
BORAX-I ENGINEERED BARRIER
SWAPP-CA

E-5

MAP OF ADDITIONAL RIP-RAP SOURCE FOR SL-1.

1) NEW DIRT ROAD TO RIP-RAP PILE TO REMAIN SINGLE LANE.

2) ALL DISTURBANCES, NEW ROADS ETC. TO BE RE-CONTOURED, RECLAIMED AND RE-SEEDED W/ CRESTED WHEATGRASS PER IT CONTRACT.

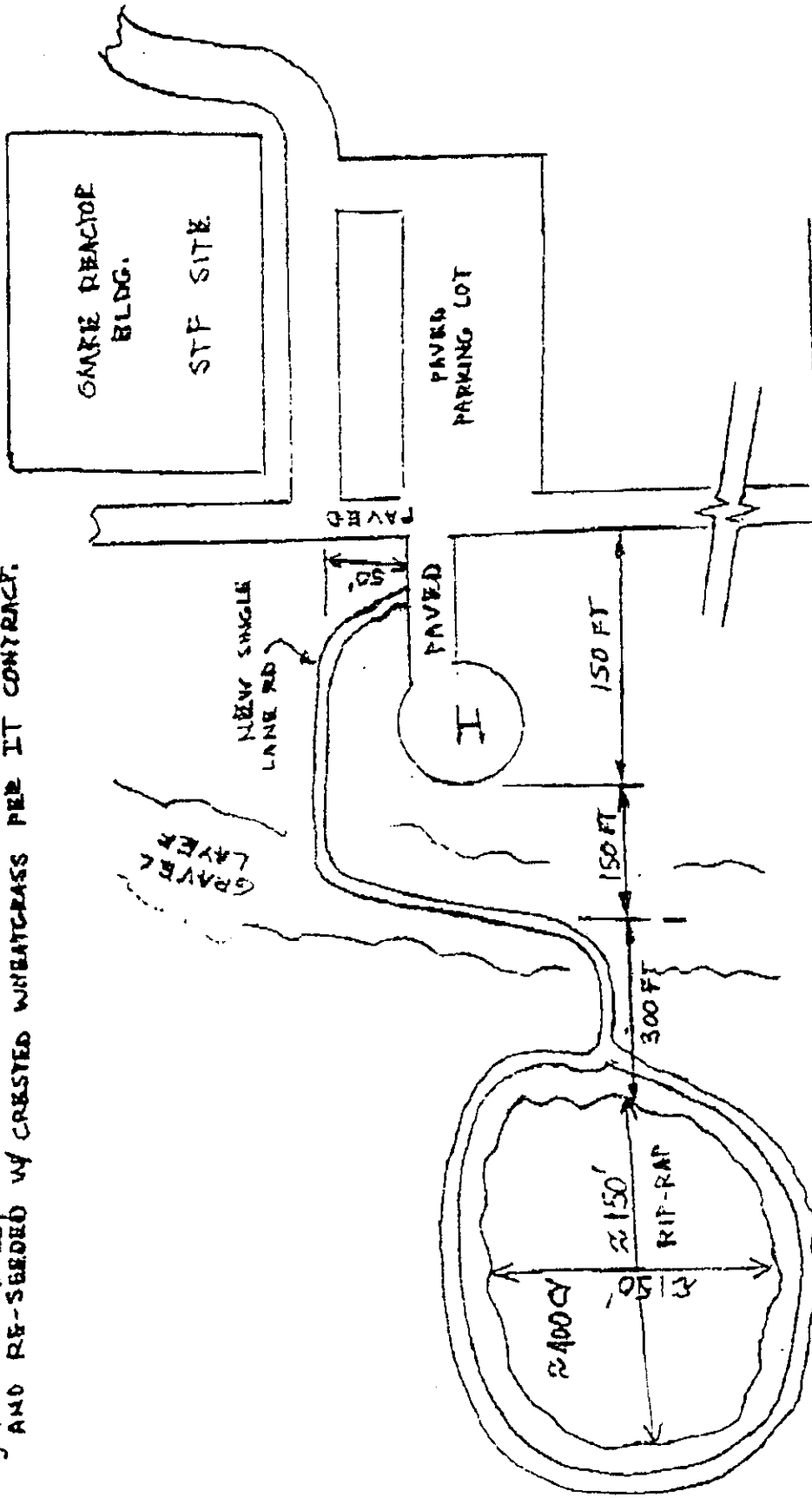

JEFFERSON AVE. TO PRF →

APPROVALS

<i>[Signature]</i>	11/17/96
<i>[Signature]</i>	11/20/96
<i>[Signature]</i>	11/20/96

REV 3
 BORAX - I / SL-1 ENGINEERED BARBER
 SW PPP - CA



DR	SHEET	OF	JOB NO	SKETCH NO	REV
OK					

MAP OF ADDITIONAL RIP-RAP SOURCE FOR SL-1 CAP.

- 1) WHEN WORKING UNDER POWER LINE WITH TRACKHOE, CONTACT RANDY SMART VIA POWER & LIGHT, 801-220-2432 FOR "HOT LINE HOLD ORDER"
- 2) ALL EXISTING ROADS TO REMAIN SINGLE LANE.
- 3) ALL DISTURBANCES, NEW TURNAROUNDS, ETC TO BE RE-CONTOURED, RECLAIMED AND RE-SEDED W/CRESTED WHEATGRASS PER IT CONTRACT.

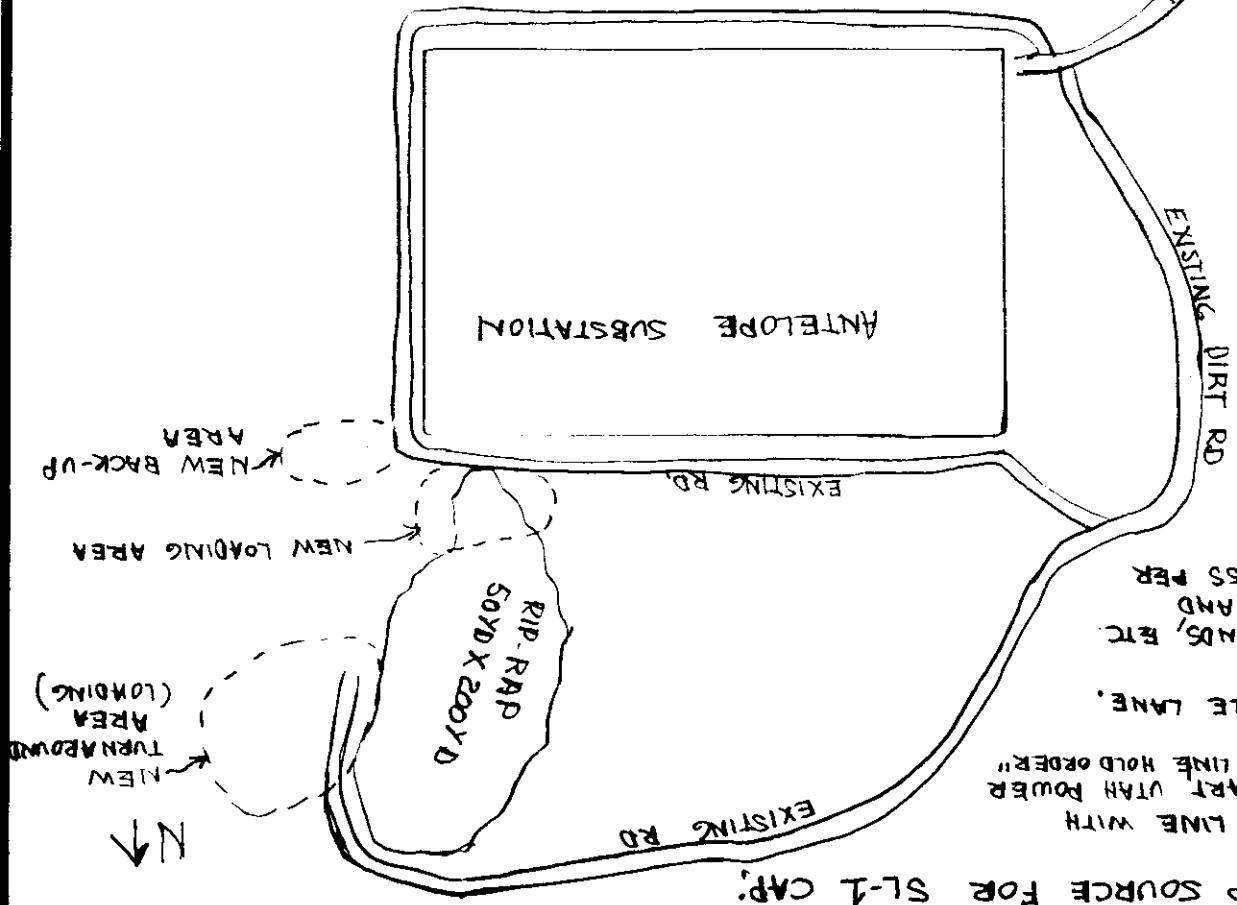

NEW TURNAROUND AREA (LOADING)
 NEW LOADING AREA
 NEW BACK-UP AREA

ANTELOPE SUBSTATION

EXISTING RD

EXISTING DIRT RD

SPRAWL

PAVED QUEBEC AVE

REV 4
 BORAX-I/SL-1 ENGINEERED BARRIER
 SWPPP - CA

APPROVALS

11.25.71
 11/25/71
 11.35.76

DR	CK	SHEET	OF	JOB NO.	SKETCH NO.	REV

